

XEROX® VERSALINK® MULTIFUNCTION PRINTER

Reliable. Budget friendly. Business ready.

B7025/B7030/B7035



ConnectKey®
Technology

xerox 

Xerox® VersaLink® B7025/B7030/B7035 Multifunction Printer

When it comes to seamless integration into your work environment and helping you get important tasks done faster, there's no smarter option than the affordable, reliable and supremely business-ready VersaLink B7025/B7030/B7035 Multifunction Printer – featuring Xerox® ConnectKey® Technology.

HIGHER PERFORMANCE. OPTIMISED EFFICIENCY.

Right out of the box, you'll count on your Xerox® VersaLink B7000 Series Multifunction Printer to consistently and flawlessly perform the tasks that make your business work more efficiently. From IT-free installation wizards, to step-by-step configuration options, you're ready to go – hassle free.

And with an entirely re-engineered paper path and new LED print head technology, we've taken day-in, day-out reliability to an impressive level of excellence.

VersaLink devices are loaded with features and time-saving Xerox® technologies designed to speed up information sharing and reduce inefficient workflows. Ensure information accuracy with Scan and Fax preview, and do more with scanned documents with built-in optical character recognition (OCR).

When it comes to safeguarding critical documents and data, VersaLink devices deliver benchmark security that protects all points of vulnerability, including protection from unauthorised device access, secure network communication, 256-bit hard disk encryption with secure overwrite and the ability to add security to individual documents.

EASY TO USE. EASY TO CUSTOMISE.

With the VersaLink B7000 Series Multifunction Printer's oversize, customisable 7-inch colour touchscreen, you can tap, swipe and pinch your way through tasks and functions with mobile-like ease.

Preloaded Xerox® ConnectKey® Apps help optimise office efficiency, and on-screen access to the extensive Xerox App Gallery provides expanded functionality – like the optional Xerox® Easy Translator Service app, which quickly translates scanned documents into numerous languages.

Get more done in less time by creating customised 1-Touch Apps to automate multi-step workflows for individuals or groups. Simply tap your new app to quickly perform the job you configured. And with Simple ID, individual users and groups enter a user ID and password once, and then enjoy fast, secure access to task-specific presets, individualised favourite contacts, and commonly used apps on a personalised home screen.

READY FOR THE WAY YOU WORK.

The VersaLink B7000 Series Multifunction Printer gives you the freedom to work where and how you want – with out-of-the-box direct connectivity to Google Drive™, Microsoft® OneDrive® and DropBox™, and access to additional options through the Xerox App Gallery.

The ability to connect and print from multiple devices is key for today's worker, and VersaLink devices meet the challenge with optional Wi-Fi® and Wi-Fi Direct®, plus Apple® AirPrint®, Google Cloud Print™, Xerox® Print Service Plug-in for Android™, Near Field Communication (NFC) Tap-to-Pair and Mopria®.

Learn more about why Xerox is the only choice for today's mobile professionals by visiting www.xerox.com/mobile.

XEROX® CONNECTKEY® TECHNOLOGY—THE CORE OF YOUR COMPLETE PRODUCTIVITY ECOSYSTEM

Xerox (the company that created the modern workplace) presents the next revolution in workplace productivity. With a consistent user experience across a wide range of devices, mobile and cloud connectivity and a growing library of apps to expand functionality, you'll work faster, better and smarter.

Intuitive User Experience

An entirely new and yet entirely familiar way to interact. Including a tablet-like experience with gesture-based touchscreen controls and easy customisation.

Mobile and Cloud Ready

Instant connectivity to cloud and mobile devices right from the user interface, with access to pre-loaded, cloud-hosted services that let you work where, when and how you want.

Benchmark Security

Multi-level protection for both documents and data, ready to guard against and eliminate emerging threats and meet or exceed regulatory compliance.

Enables Next Generation Services

Work more efficiently and manage resources more effectively. Easy integration of Xerox® Managed Print Services enables remote monitoring of service delivery and consumables.

Gateway to New Possibilities

Instantly extend your capabilities with access to the Xerox App Gallery, featuring real-world apps designed to optimise digital workflows. Commission our network of partners to design innovative, business-specific solutions.

Find out more about how you'll work smarter at www.connectkey.com.

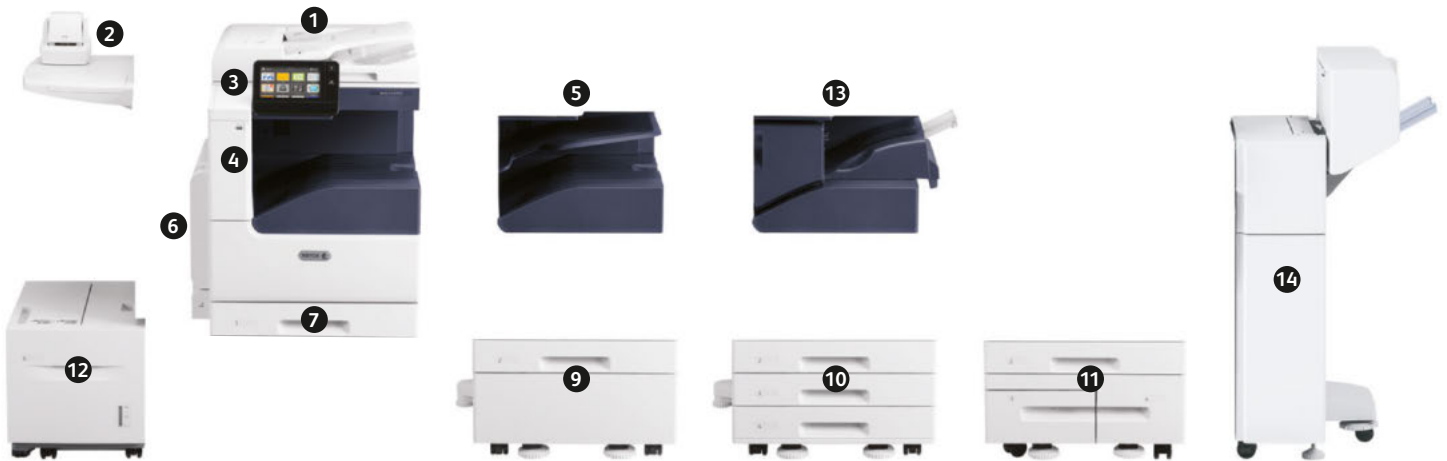

- 1** A 110 Sheet **Duplex Automatic Document Feeder (DADF)** scans two-sided black and white or colour originals for copy, scan and fax jobs.
- 2** Optional **Work Surface** (shown with optional Convenience Stapler) gives you plenty of room to sort documents.
- 3** **Card Reader Bay** with embedded USB port.¹
- 4** An easily accessible **USB port**¹ allows users to quickly print from or scan to any standard USB memory device.
- 5** The optional **Dual Catch Tray** stacks up to 250 sheets each level. Lower level tray offsets.
- 6** The 100 Sheet **Bypass Tray** handles media sizes from 3.5 x 3.87 in. to 11.69 x 17 in./88.9 x 98.4 mm to 297 x 431.8 mm.
- 7** The standard 520 Sheet **Tray 1** handles media sizes from 5.5 x 7.17 in. to 11.69 x 17 in./139.7 x 182 mm to 297 x 431.8 mm.

¹ USB ports can be disabled.

ADDITIONAL PAPER TRAY CONFIGURATION EXAMPLES:



CHOOSE FROM 1 OF THE 5 ADDITIONAL STACKING OPTIONS BELOW (8, 9, 10, 11) TO INCREASE PAPER CAPACITY:

- 8** The **Single Tray Module** increases the total paper capacity to 1,140 sheets (includes Bypass Tray).
- 9** The **Single Tray with Stand Module** increases the total paper capacity to 1,140 sheets (includes Bypass Tray) and provides storage for toner and other supplies.
- 10** Choose the **Three Tray Module** to increase the total paper capacity to 2,180 sheets (includes Bypass Tray).
- 11** The **High-Capacity Tandem Tray Module** allows for a total paper capacity of up to 3,140 sheets (includes Bypass Tray).
- 12** The optional **High-Capacity Feeder** (requires either option 9, 10 or 11) holds 2,000 sheets of letter/A4 paper, increasing the maximum paper capacity to 5,140 sheets.

ADD INCREASED VERSATILITY WITH FINISHING OPTIONS:

- 13** The **Integrated Office Finisher** provides 500-sheet stacking and 50-sheet, single-position stapling.
- 14** The optional **Office Finisher LX** gives you advanced finishing functions at a great value and offers optional booklet making.



INTRODUCING TOUCHSCREEN SUPERIORITY

Meet our all-new, 7-inch colour touchscreen – the user interface that sets a higher standard for customisation, personalisation and versatility.

By presenting a familiar “mobile” experience – with support for gestural input and task-focused apps that share a common look and feel – fewer steps are needed to complete even the most complex jobs.

A highly intuitive layout guides you through every task from start to finish, with a natural hierarchy placing critical functions near the top of the screen and commonly used options front and centre. Don't like where a function or app is located? Customise the layout to make it yours.

This unmatched balance of hardware technology and software capability helps everyone who interacts with the VersaLink® B7000 Series Multifunction Printer get more work done, faster.

The VersaLink B7025/B7030/B7035 Multifunction Printer is built on Xerox® ConnectKey® Technology.
For more information, visit www.connectkey.com.

DEVICE SPECIFICATIONS		VersaLink B7025	VersaLink B7030	VersaLink B7035
Speed		Up to 25 ppm	Up to 30 ppm	Up to 35 ppm
Monthly Duty Cycle ¹		Up to 107,000 pages	Up to 129,000 pages	Up to 153,000 pages
Processor/Memory (Standard)		1.05 GHz Dual core/2 GB Memory		
Hard Drive (Optional)		320 GB		
Connectivity		Ethernet 10/100/1000 Base-T, High-speed USB 3.0, Wi-Fi® and Wi-Fi Direct® with optional Wi-Fi Kit		
Controller Features		Unified Address Book, Configuration Cloning, Scan Preview, Xerox Extensible Interface Platform®, Xerox App Gallery, Xerox® Standard Accounting, Role Based Permissions, Convenience Authentication Enabled, Online Support		
Copy and Print	Resolution	Copy: Up to 600 x 600 dpi; Print: Up to 1200 x 1200 dpi		
First-copy-out Time (as fast as)		As fast as 6.8 seconds	As fast as 5.4 seconds	As fast as 5.4 seconds
First-print-out Time		As fast as 10.4 seconds	As fast as 9.1 seconds	As fast as 9.1 seconds
Page Description Languages		PCL® 5e/PCL 6/PDF/XPS/TIFF/JPEG/HP-GL/optional Adobe® PostScript® 3™		
Paper Input	Standard	Duplex Automatic Document Feeder (DADF): 110 sheets; Standard sizes: 5.5 x 8.5 in. to 11 x 17 in./A5 to A3; Custom sizes (duplex): 4.92 x 4.33 in. to 11.69 x 17 in./125 x 110 mm to 297 x 431.8 mm; Custom sizes (simplex): 4.92 x 3.35 in. to 11.69 x 17 in./125 x 85 mm to 297 x 431.8 mm		
		Bypass Tray: 100 sheets; Custom sizes: 3.5 x 3.87 in. to 11.69 x 17 in./88.9 x 98.4 mm to 297 x 431.8 mm		
		Tray 1: 520 sheets; Custom sizes: 5.5 x 7.17 in. to 11.69 x 17 in./139.7 x 182 mm to 297 x 431.8 mm		
	Optional	Single Tray Module: 520 sheets; Custom sizes: 5.5 x 7.17 in. to 11.69 x 17 in./139.7 x 182 mm to 297 x 431.8 mm Single Tray with Stand: 520 sheets; Custom sizes: 5.5 x 7.17 in. to 11.69 x 17 in./139.7 x 182 mm to 297 x 431.8 mm Three Tray Module (1,560 sheets): 520 sheets each; Custom sizes: 5.5 x 7.17 in. to 11.69 x 17 in./139.7 x 182 mm to 297 x 431.8 mm High-Capacity Tandem Tray (2,520 sheets): Tray 2: 520 sheets; Custom sizes: 5.5 x 7.17 in. to 11.69 x 17 in./139.7 x 182 mm to 297 x 431.8 mm; Tray 3: 870 sheets; Standard sizes: 8.5 x 11 in. and 7.25 x 10.5 in./A4 or B5; Tray 4: 1,130 sheets; Standard sizes: 8.5 x 11 in. and 7.25 x 10.5 in./A4 or B5 Envelope Tray: Up to 60 envelopes: #10 commercial, Monarch, DL, C5; Custom sizes: 3.9 x 5.8 in. to 6.4 x 9.5 in./98 x 148 mm to 162 x 241 mm High-Capacity Feeder (HCF): 2,000 sheets; Standard sizes: 8.5 x 11 in. and 7.25 x 10.5 in./A4 or B5		
Paper Output/Finishing	Standard	500-sheet Centre Tray		
	Optional	Dual Catch Tray: 250 sheets each; Lower tray offsets Integrated Office Finisher: 500-sheet stacker, 50 sheets stapled, single-position stapling Office Finisher LX: 2,000-sheet stacker, 50 sheets stapled, 3-position stapling, optional hole-punch, optional booklet maker (score, saddle stitch) Convenience Stapler with optional Work Surface: Staples 50 sheets		

INTUITIVE USER EXPERIENCE

Customise and Personalise	Walkup customisation, Personalise Home Screen by User, Multiple Home Screens with Simple ID, Customise by Site, Function or Workflow with Xerox App Gallery and Xerox® App Studio
Print Drivers	Job Identification, Bidirectional Status, Job Monitoring, Xerox® Global Print Driver® and Mobile Express Driver®
Xerox® Embedded Web Server	Access via PC, Mobile and Tablet – Status Information, Responsive Design, Settings, Device Management, Cloning
Preview	Preview of Scan/Fax with Zoom, Rotate, Add Page
Print Features	Print from USB, Secure Print, Sample Set, Personal Print, Saved Job, Xerox® Earth Smart Driver Settings, Job Identification, Booklet Creation, Store and Recall Driver Settings, Bidirectional Real-time Status, Scaling, Job Monitoring, Application Defaults, Two-sided Printing (as default), Skip Blank Pages, Draft Mode
Scan	Optical Character Recognition (OCR), Scan to USB/Email/Network (FTP/SMB), Scan File Formats: PDF, PDF/A, XPS, JPEG, TIFF; Convenience Features: Scan to Home, Searchable PDF, Single/Multi-Page PDF/XPS/TIFF/Password Protected PDF
Fax ²	Optional Walk-up Fax (one-line or three-line options available, includes LAN Fax, Direct Fax, Fax Forward to Email), optional Fax Over IP

MOBILE AND CLOUD READY

Mobile Printing	Apple® AirPrint® ⁵ , Google Cloud Print™ Ready, Xerox® Print Service and Mopria® Print Service Plug-ins for Android™, @PrintByXerox
Mobility Options	Xerox® Mobile Print and Mobile Print Cloud ⁴ , Connect via NFC/Wi-Fi Direct Printing ⁴ , Xerox® Mobile Link App ³ . Visit www.xerox.com/officemobileapps for available apps.
Cloud Connectors ³	Print from/Scan to Google Drive™, Microsoft® OneDrive®, Dropbox™, Microsoft Office 365®, Box®, Xerox® DocuShare® Platform ⁴ and more

BENCHMARK SECURITY

Network Security	IPsec, HTTPS, encrypted email, Network Authentication, SNMPv3, SSL/TLS, Security Certificates, Pre-installed Self-signed Certificates, Cisco® Identity Services Engine (ISE) integration
Device Access	Firmware Verification, User access and internal firewall, Port/IP/Domain Filtering, Audit Log, Access Controls, User Permissions, Smart Card Enabled (CAC/PIV.NET), Xerox® Integrated Card Reader Bay
Data Protection	Setup/Security Wizards, Job Level Encryption via HTTPS/IPPS submission, Encrypted hard disk (AES 256-bit, FIPS 140-2) and image overwrite, Common Criteria Certification (ISO 15408) (undergoing evaluation), Encrypted Apps with Embedded Certificate Support
Document Security	Secure Print, Secure Fax, Secure Email, Password Protected PDF

ENABLES NEXT GENERATION SERVICES

Print Management	Xerox® Print Management and Mobility Suite ⁴ , Configuration Cloning, Xerox® Standard Accounting, Equitrac ⁴ , Y Soft ⁴ and more
Managing Print	Xerox® Device Manager, Xerox® Support Assistance, Auto Meter Read, Managed Print Services tools
Sustainability	Cisco EnergyWise®, Earth Smart Printing, Print User ID on margins

GATEWAY TO NEW POSSIBILITIES

Cloud Services	Xerox® Easy Translator ⁴ , CapturePoint™ ⁴ , many additional services available
Xerox App Gallery	Many apps and cloud services available. Visit www.xerox.com/appgallery for a growing selection of Xerox® apps available for adding functions to the Printer/MFP.

¹ Maximum volume capacity expected in any one month. Not expected to be sustained on a regular basis; ² Requires analogue phone line; ³ Free optional download from Xerox App Gallery to the Printer – www.xerox.com/xeroxappgallery; ⁴ Purchased option; ⁵ Visit www.apple.com for AirPrint Certification list.

For more detailed specifications, go to www.xerox.com/VersaLinkB7000Specs.